

FORM B - BUILDING

Area F	Form no. 175
-----------	-----------------

MASSACHUSETTS HISTORICAL COMMISSION



City Newburyport
 Address 26-28 Marlboro Street
 Historic Name Hale House
 Original Residence
 Present Residence
 Ownership: Private individual
 Private organization _____
 Public _____
 Original owner Unknown

Draw map showing property's location in relation to nearest cross streets and other buildings or geographical features. Indicate north.

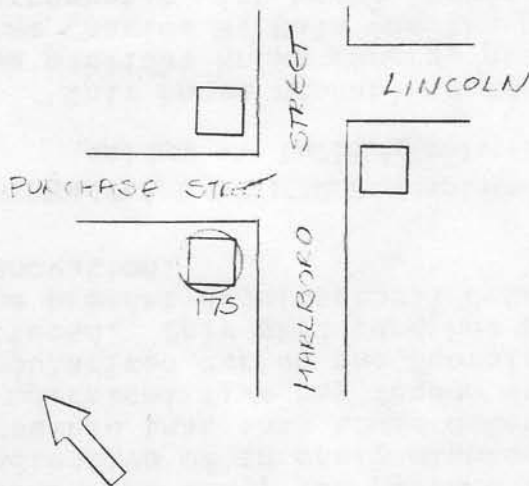

DESCRIPTION:

Date Early eighteenth century
 Source _____
 Style Possibly First Period
 Architect Unknown
 Exterior wall fabric Clapboards
 Outbuildings _____
 Major alterations (with dates) front entrance altered, addition at rear, (dates unknown)
 Moved _____ Date _____
 Approx. acreage 6,850 sq. ft.
 Setting in residential area of predominantly eighteenth century single family dwellings adjacent to the banks of the Merrimack River.

Recorded by Mary Jane Stirgwolt
 Organization Office of Community Development
 Date 11-01-80

(Staple additional sheets here)

ARCHITECTURAL SIGNIFICANCE (describe important architectural features and evaluate in terms of other buildings within community)

Architecturally this house is of interest because it has an early form. The long, low pitched roof and the massive center chimney are indicative of an early eighteenth century construction date. It is quite possible that this house dates from the early eighteenth century. The symmetrical five bay facade is influenced by the formalization of facade popularized during the Georgian period. The front entrance has been altered. This structure has been rehabilitated in recent years. Much of the present architectural detail probably dates from this period of renovation.

HISTORICAL SIGNIFICANCE (explain the role owners played in local or state history and how the building relates to the development of the community)

This house probably dates from the early years of the eighteenth century. The earliest known owners, are those of the late nineteenth century. At that time Charles W. Hale was the proprietor of this building. Hale was in partnership with Moses Stevens under the firm name of Charles W. Hale and Company. This firm dealt in fish and the business was located on Bartlet's Wharf. Charles W. Hale also served as alderman from Ward One in 1857.

Hale had a fish yard and fish flakes for the drying of fish on a parcel of land off of Madison Street in the Joppa district. The flake yard had been established by Enock Woodwell, Jr. This land remained in the Hale family until 1960. It was set aside as the Hale Memorial Park according to the bequest of Joseph W. L. Hale.

BIBLIOGRAPHY and/or REFERENCES

- Assessor's Records 1890-1980
- 1872 Map of the City of Newburyport, Mass. D. G. Beers and Co.
- 1872 City Directories
- 1884 Atlas of Essex County, G. H. Walker Co.
- J. J. Currier, History of Newburyport 1764-1905, vols. I and II., reprint, Newburyport 1977.
- R. Woodwell, "Introduction to Joppa" typescript, Newburyport Historical Commission.