

27 ASHLAND ST – The Moses A. Currier House



Location

27 ASHLAND ST

MBLU

66/ 22/ / /

Owner

DELAHANTY KEVIN C

Assessment

\$1,540,500

PID

4345

Building Count

1

Current Value

Assessment

Valuation Year	Improvements	Land	Total
2026	\$1,052,300	\$488,200	\$1,540,500

Owner of Record

Owner DELAHANTY KEVIN C
Co-Owner DELAHANTY JOAN E T/E
Address 27 ASHLAND ST
 NEWBURYPORT, MA 01950
Sale Price \$725,000
Certificate
Book & Page 26088/0162

Sale Date 09/15/2006
Instrument 00

Ownership History

Ownership History

Owner	Sale Price	Certificate	Book & Page	Instrument	Sale Date
DELAHANTY KEVIN C	\$725,000		26088/0162	00	09/15/2006
PATTERSON BROOKS CURTISS	\$320,000		15321/0130	00	12/14/1998
DEZENZO JEAN L	\$1		10970/0450	1A	10/07/1991
DEZENZO FRANK	\$118,000		07294/0078	00	12/15/1983
MASON AND LAMBERT INC	\$65,000		07014/0649	00	12/13/1982

Building Information

Building 1 : Section 1

Year Built: 1845
Living Area: 2,665

Building Attributes

Field	Description
Style:	Antique

Model	Residential
Grade:	Average +20
Stories:	2 Stories
Occupancy	1
Exterior Wall 1	Clapboard
Exterior Wall	
Roof Structure:	Gable/Hip
Roof Cover	Asph/F Gls/Cmp
Interior Wall1	Plastered
Interior Wall	Drywall/Sheet
Interior Flr	Pine/Soft Wood
Interior Flr 2	Hardwood
Heat Fuel	Gas
Heat Type:	Forced Air-Duc
AC Type:	Central
Total Bedrooms:	3 Bedrooms
Total Bthrms:	2
Total Half Baths:	1
Total Xtra Fixtrs:	
Total Rooms:	7 Rooms
Cndtn	
Num Park	
Fireplaces	
Fndtn Cndtn	
Basement	

Building Layout

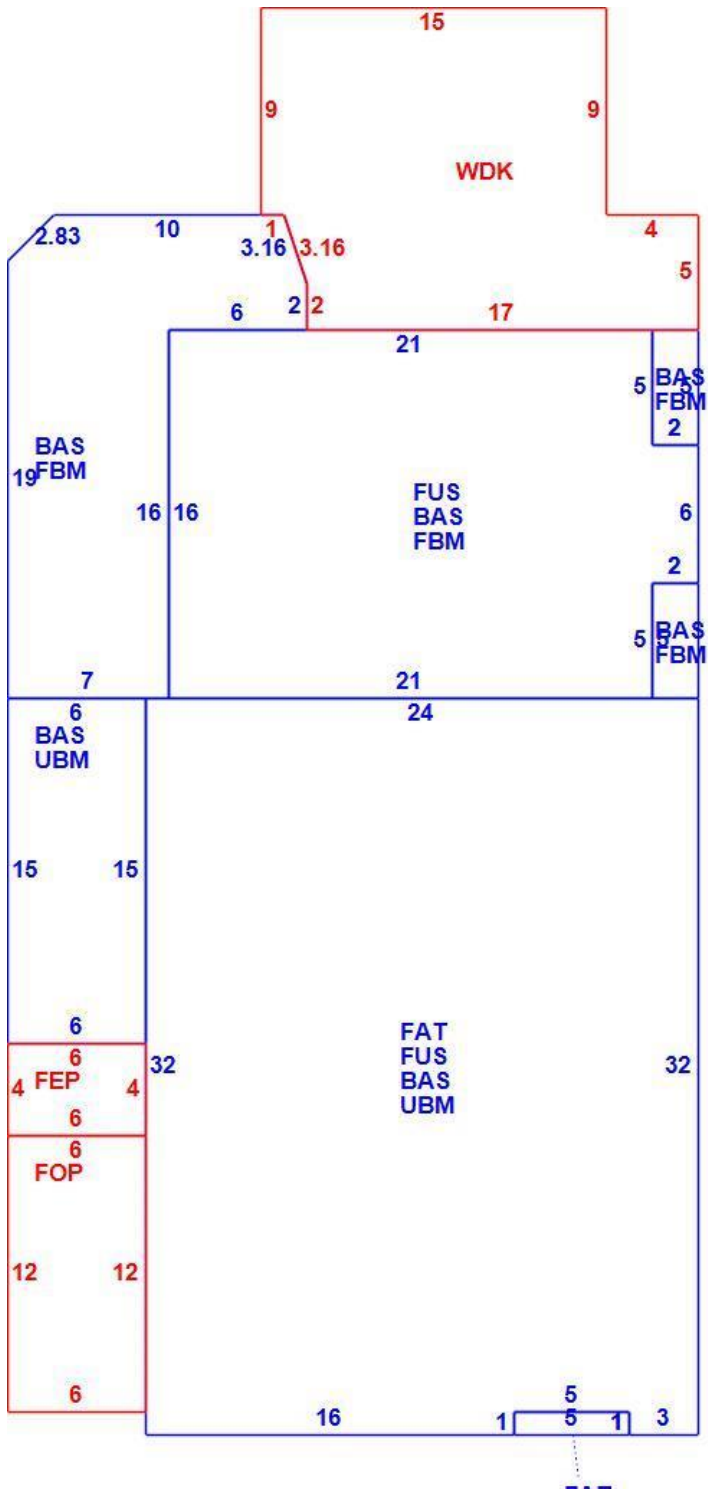

Building Sub-Areas (sq ft) Legend

Code	Description	Gross Area	Living Area
BAS	First Floor	1,395	1,395

FUS	Upper Story, Finished	1,116	1,116
FAT	Attic	768	154
FBM	Basement, Finished	542	0
FEP	Porch, Enclosed	24	0
FOP	Porch, Open	77	0
UBM	Basement, Unfinished	853	0
WDK	Deck, Wood	222	0
		4,997	2,665

Extra Features

Extra Features Legend

Code	Description	Size	Value	Bldg #
FPL3	FIREPLACE 2 ST	2.00 UNITS	\$7,900	1
FPO	EXTRA FPL OPEN	4.00 UNITS	\$3,200	1

Land

Land Use

Use Code 1010
Description SINGLE FAM

Land Line Valuation

Size (Acres) 0.22
Depth 0
Assessed Value \$488,200

Outbuildings

OutbuildingsLegend

Code	Description	Sub Code	Sub Description	Size	Value	Bldg #
BRN3	1 STORY W/LOFT			320.00 S.F.	\$5,100	1

Valuation History

Assessment

Valuation Year	Improvements	Land	Total
2025	\$1,052,300	\$456,300	\$1,508,600
2024	\$1,005,300	\$414,800	\$1,420,100
2023	\$864,200	\$360,700	\$1,224,900

History of the House

Architecture: Sidehall Greek Revival/house & stable, ca 1850

History

Moses A. Currier (1823 -1875) was the nephew of John J. Currier Jr. the famous shipbuilder who owned the shipyard on Merrimac Street. In 1845 he bought land on Pillsbury Street, which at that time was part of Newbury. In 1851 the land became part of Newburyport, and the name was changed to Ashland Street in 1852. Moses probably built his house around 1845.

His Obituary in 1875 says, "Mr. Currier was born in Belleville, and followed the business of his ancestors and family, for he belonged to a race of shipbuilders. He was for many years in the employ of Currier & Townsend and took the contracts to put in the decks of every vessel built by them in this city, including the noted ship Dreadnaught, and he frequently had in his employ, from sixty to seventy men. After Currier & Townsend stopped business, he did the same kind of work for his uncle, John Currier Jr., and continued to work on his uncle's vessels until failing health compelled him to cease from active labor about six years ago. Mr. Currier was a man of fine character and was respected and liked by all who knew him. He was a skillful and ingenious mechanic, and a man of fine taste, which quality he showed in his work, and indeed, in everything he he did. His ingenuity was displayed in improvements which he made in putting in the decks of ships, which have been generally adopted since."

Moses first married Dolly E. Blaisdell of Salisbury, she died in January 25, 1850, at the age 24. Their two twin girls born in 1847 died at 3 months. Moses married Elizabeth Goodwin Currier (1828-1900) on May 14, 1850, he was 27 and she was 21. They had 4

children, 3 who lived, John Atkinson Currier, Orra L. Currier, and Eunice Atkinson Currier

John married Sadie Alexander in 1879. The 1880 Census shows that they were living with his mother Elizabeth at 27 Ashland; John was 28, Sadie was 26. Eunice was 15 and Orra had married Edward Williams; she was 25 and he was 30. They were also living there with their child Carrie who was 3. It was a full, multi-generational household. When Elizabeth died in 1900, she left the house to her 3 children. In 1901 John was given 27 Ashland Street by his two sisters and their husbands.

John died in 1917, he was a marine engineer for steamboats. Sadie's estate sold the house in 1927. 27 Ashland Street had been in the family from 1845-1927.

References:

History compiled by Mary Baker Eaton, www.historynewburyport.org

Salem Deeds

History of Newburyport, 1764-1905 by John J Currier

Newburyport Herald, February 10, 1875

Find A Grave

Newburyport Daily Herald, January 25, 1850

Heritage Quest online, the Newburyport Public Library Archival Center

Newburyport City Directories

FamilySearch.org

Newburyport Historic Papers, the Newburyport Public Library Archival Center

1872 Map of Newburyport, Courtesy of the Newburyport Public Library Archival Center

1884 Map, Courtesy of the Newburyport Public Library Archival Center

The Newburyport Public Library Archival Center